

# FEKABOX 200

## 1 PUMP AUTOMATIC LIFTING STATIONS



### TECHNICAL DATA

**Operating range:** from 1 to 24 m<sup>3</sup>/h with head up to 15 metres.

**Pumped liquid:** ground water, rain water, clear waste water, grey waste water, and river or lake water.

Liquids compatible with EN12050 1/2.

**Maximum temperature of liquid:** 45 °C

**Installation:** Secured to the floor if inside a building. Underground if outside the building.

It cannot be driven on, but it can be walked on, maximum weight 100 kg.

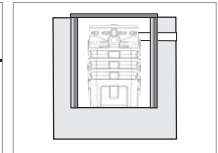
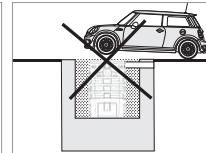
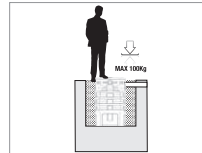

### APPLICATIONS

Pumping stations suitable for the collection and redirection to the sewer network, of domestic drain water (waste, dirty, rain), of basements and garages, for one or more dwellings, when the sewer network cannot be reached due to gravity issues.

### CONSTRUCTION FEATURES

**CAPACITY:** 200 lt

**MATERIALS:** LLDPE

**STANDARDS** 12050-1

#### CONNECTIONS

- DN 50/110 inputs
- DN 50 ventilation
- G2" output

#### COMPONENTS INCLUDED:

- 2" PP lifting device  
and rotation prevention bracket for FEKA VS and VX
- Cable gland for individual pump
- 2" F x 1 x ¼ M connector for FEKA 600
- FEKA VS and VX float cable stop kit

#### COMPONENTS NOT INCLUDED

- Pump: to be selected according to the possible configurations
- Alarm float support

### PUMP INSTALLATION

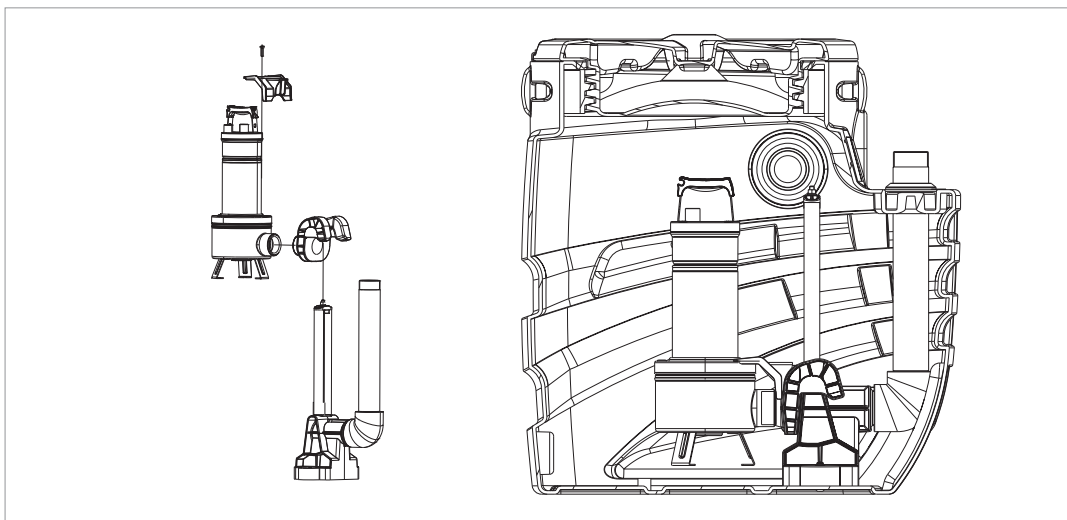

# FEKABOX 200 - WASTE WATER AUTOMATIC COLLECTION AND LIFTING STATIONS

Maximum temperature of liquid: 45°C

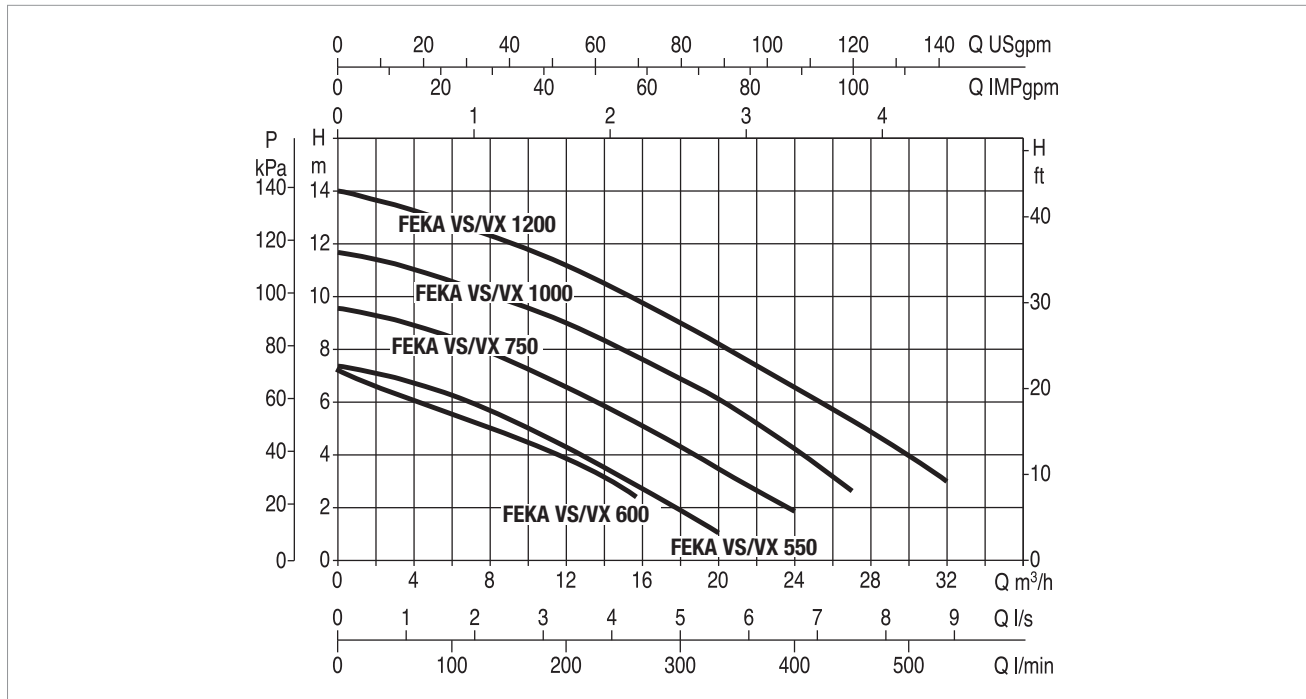

The performance curves are based on kinematic viscosity values = 1 mm²/s and density equal to 1000 kg/m³. Curve tolerance according to ISO 9906.

## CONFIGURATIONS

PUMP MODEL	ELECTRICAL DATA				
	POWER INPUT 50 HZ	P1 MAX kW	P2 NOMINAL		In A
			kW	HP	
FEKA 600 M-A	1X220-240 V~	1	0.55	0.75	4.3
FEKA VS/VX 550 M-A	1X220 - 240 V~	0.9	0.55	0.75	4.2
FEKA VS/VX 750 M-A	1X220 - 240 V~	1.1	0.75	1	5.13
FEKA VS/VX 1000 M-A	1X220 - 240 V~	1.4	1	1.36	6.63
FEKA VS/VX 1200 M-A	1X220 - 240 V~	1.9	1.2	1.6	8.63

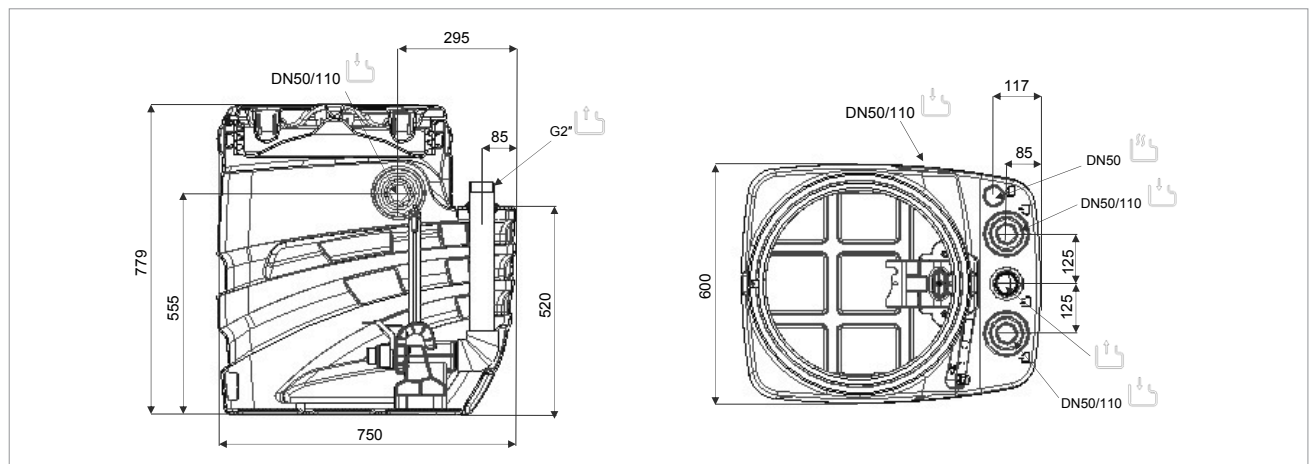

## SIZES AND WEIGHTS

PACKING DIMENSIONS			WEIGHT Kg
L/A	L/B	H	
750	600	779	23.2

### LEGEND:

- Emergency output or delivery piping connection
- Collection piping input
- Power and float cable output
- Ventilation pipe connection
- Recyclable material